

- 1 The Keyboard tray can move in or out

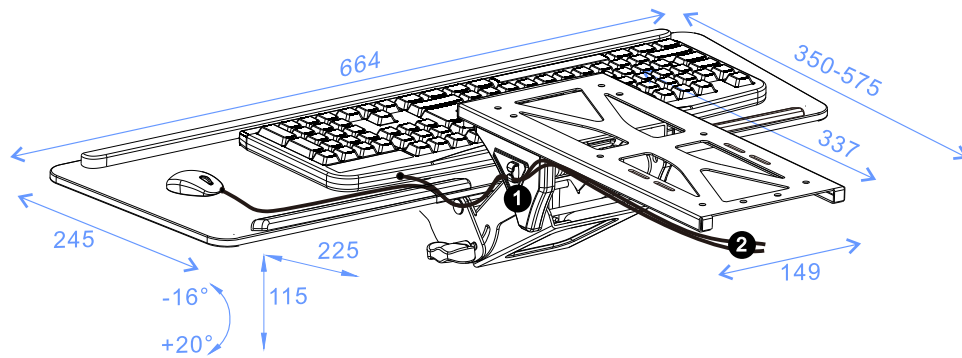

- 2 There is glue on the top side of the clip, this is to help keep your cables in place

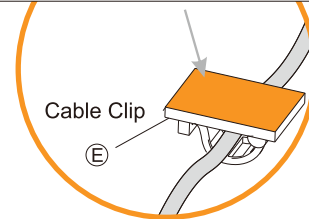

Use the cable clip (E) to organize your cables by attaching them onto the clip.



### Attention

This product contains small items that could be a choking hazard if swallowed. Keep these items away from young children.

- The desk or mounting surface must be capable of supporting the combined weight of the mount and the display, otherwise the structure must be reinforced.
- Safety gear and proper tools must be used. A minimum of two people are required for this installation. Failure to use safety gear can result in property damage, or serious injury
- please check joint parts every two months, making sure the screws are not loosened.

This product was designed to be installed on a desk. Before installing, make sure the mount will support the combined load of the equipment and hardware. Never exceed the maximum load capacity 12 KG, or else it may result in product failure or personal injury.

Note: this product is intended for indoor use only. Use of this product outdoors could lead to product failure or personal injury

### The App

To get the most out of your Sit-Stand Desk, connect it to our Ergonomyx App once you have assembled and plugged in the desk. Our App allows you to unlock awesome features.



SCAN ME



SCAN ME

You can find a detailed breakdown and instructions on all of our app's features in the instruction manual on our website.

### Waste disposal



This marking indicates that this product should not be disposed with other household wastes. To prevent possible harm to the environment or human health from uncontrolled waste disposal, recycle it responsibly to promote the sustainable reuse of material resources. To return your used device, please use the return and collection systems or contact the retailer where the product was purchased. They can take this product for environmentally safe recycling.

Welcome to the Ergonomyx Family!

Thank you for choosing Ergonomyx! We are excited to be part of your new and improved office space, we want to help you get the most out of your working day!

For more information please visit  
<https://www.ergonomyx.com/desk-resources>

### Parts List

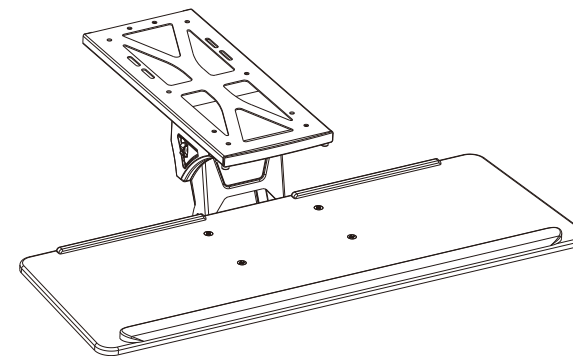

Attention: The drawings below are only for reference which might be slightly different than the actual object. If there are any tools missing or installation problems, please contact customer service.

No.	Image	Spec	Qty
A		Wood Screw	8
B		Washer	8
C		M4 Bolt	2
D		M5 Bolt	4
E		Cable Clip	2

### Component List

①	Installation Panel	1 pc
②	Holder	1 pc
③	Keyboard Tray	1 pc
④	Long Pad	1 pc
⑤	Plastic Cap	1 pc
⑥	Corner Connector	4 pc

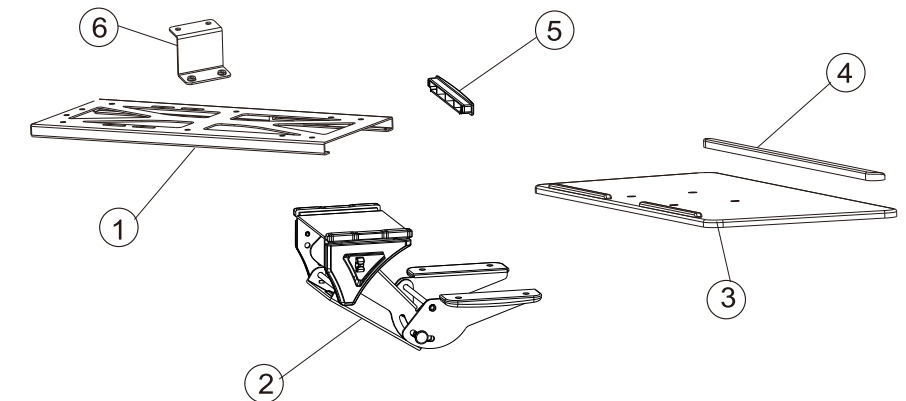

## 1 Flip Desk and unscrew cross beam screws

Note: Skip step if installing on other desks that are not Ergonomyx

Loosen the Crossbeam and match to tabletop length, then tighten with Allen Key.

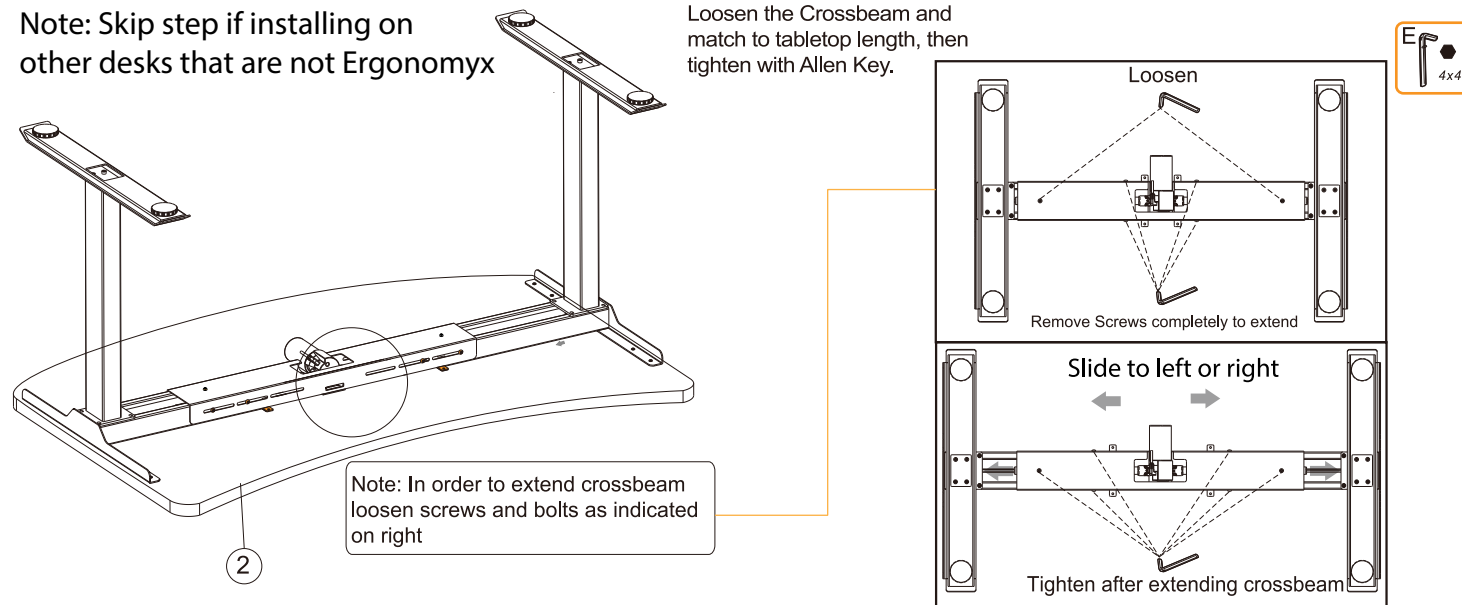

## 2 Option A: Install panel to the table board

1 Measure and mark the spots to be drilled on (35mm from table edge)

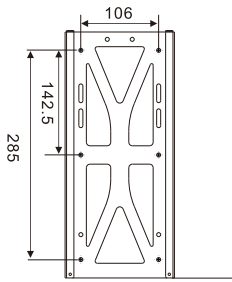

Install the panel where the keyboard tray should be installed .

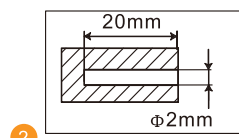

Note: Use 1/8th in drill bit (2mm) for pilot hole

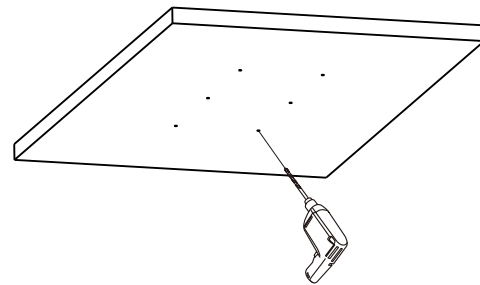

Drill the marked spots

### Attention

The panel's opening should be facing outwards during installation

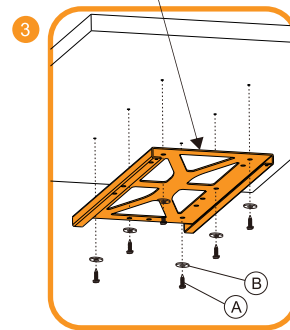

Install the panel under the table board with screws A and washers B, and then tighten the screws.

## 3 Option B: Angled corners are suitable for tables with beams

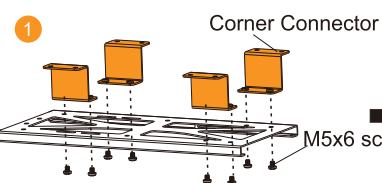

2 Measure and mark the spots to be drilled on (55mm from table edge)

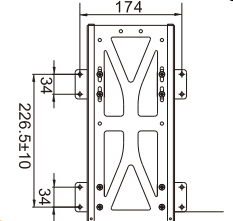

Attention: Install the panel where the keyboard tray should be installed .

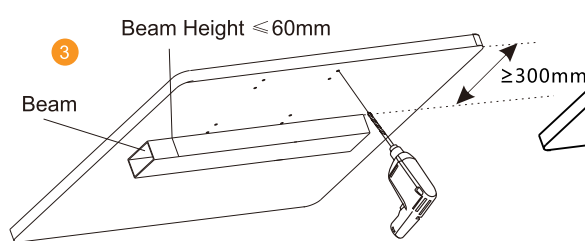

Drill the marked spots

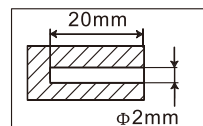

Note: Use 1/8th in drill bit (2mm) for pilot hole

NOTE: Do not install the panel on panel's opening.

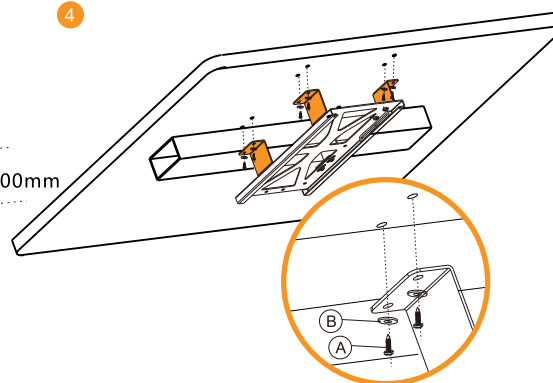

Install the panel under the table board with screws A and washers B, and then tighten the screws.

## 4 Install holder

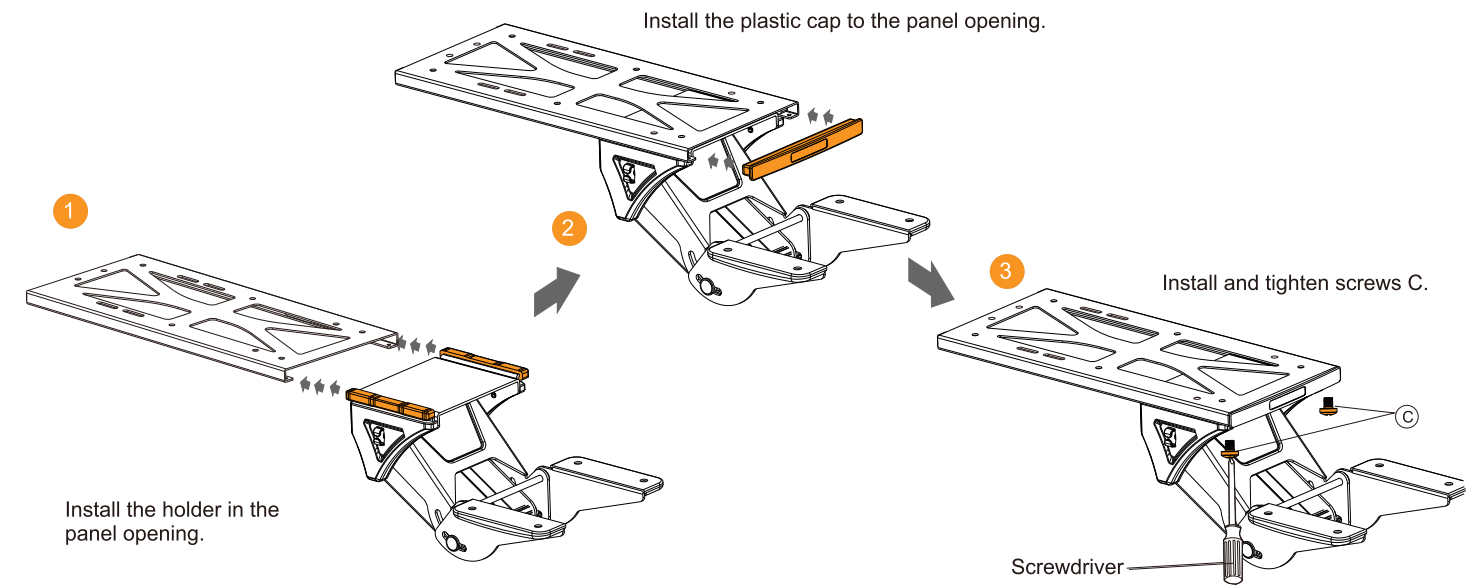

## 5 Install keyboard tray

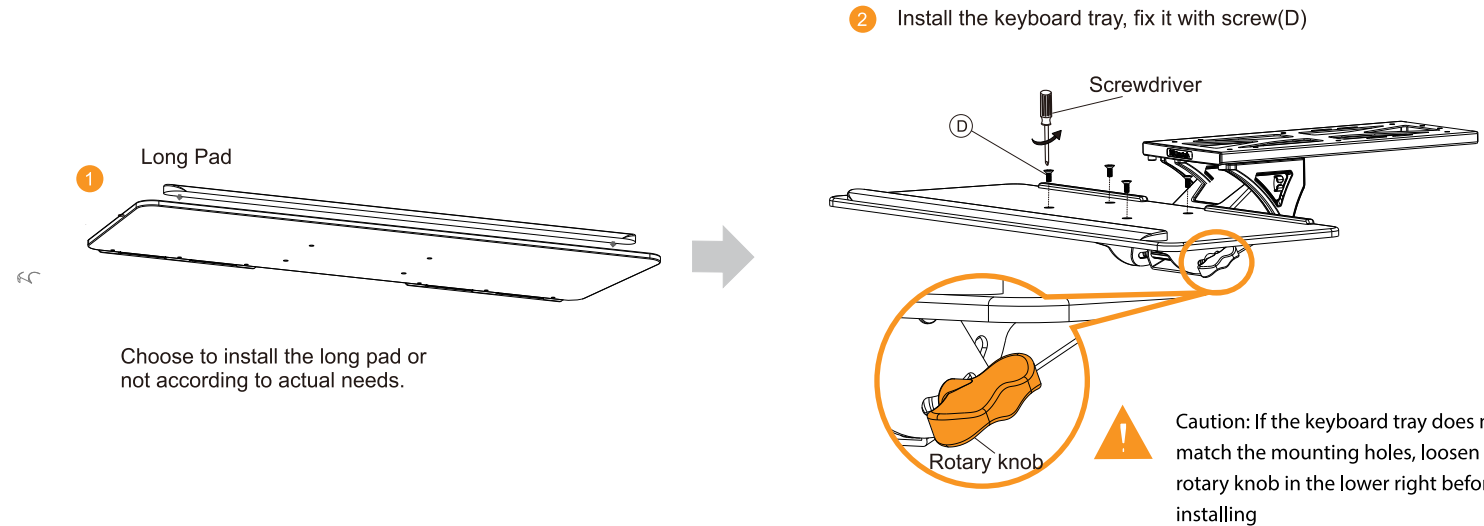

## 6 Adjust the Keyboard tray

